

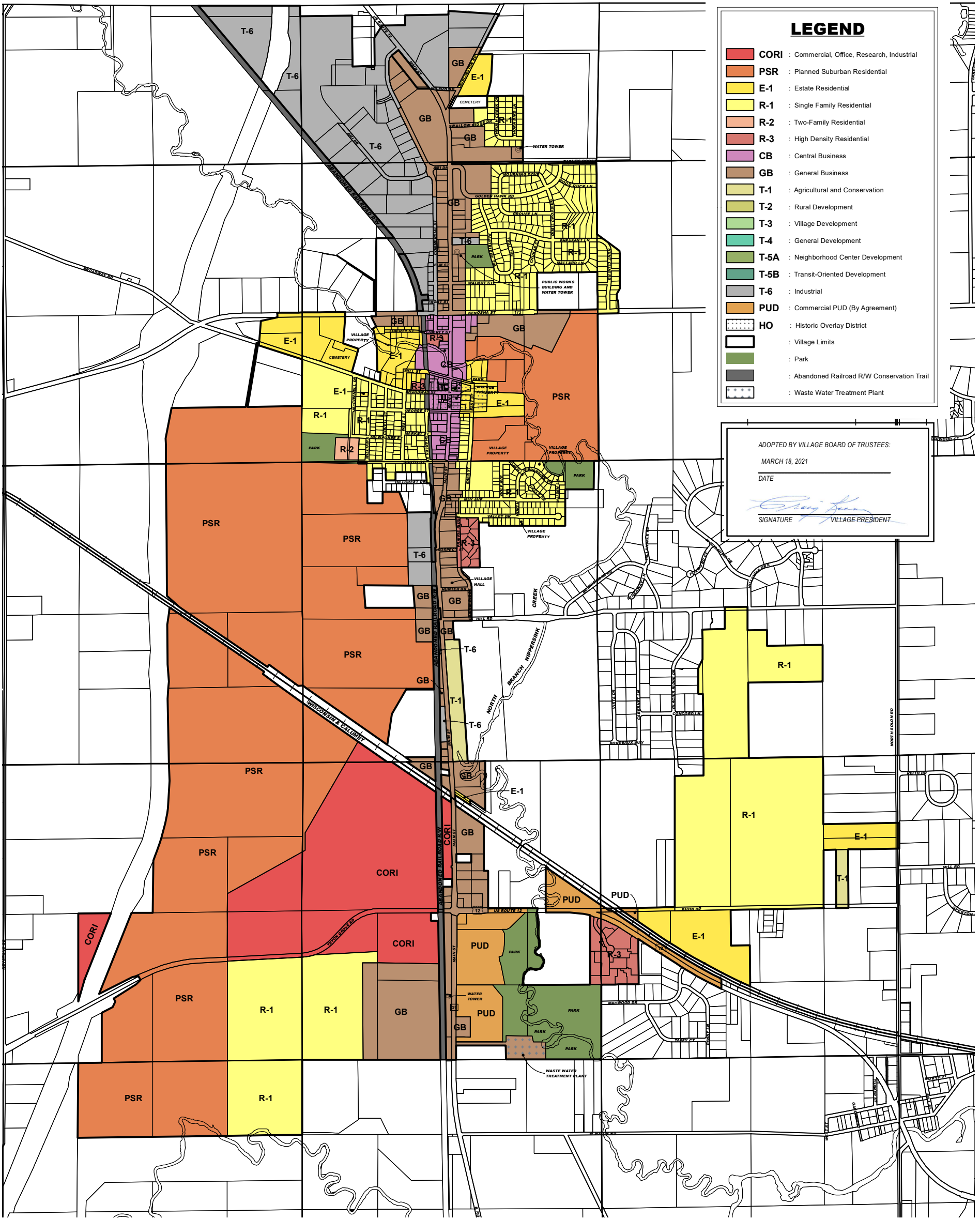

VILLAGE OF RICHMOND ZONING MAP



LEGEND	
■	CORI : Commercial, Office, Research, Industrial
■	PSR : Planned Suburban Residential
■	E-1 : Estate Residential
■	R-1 : Single Family Residential
■	R-2 : Two-Family Residential
■	R-3 : High Density Residential
■	CB : Central Business
■	GB : General Business
■	T-1 : Agricultural and Conservation
■	T-2 : Rural Development
■	T-3 : Village Development
■	T-4 : General Development
■	T-5A : Neighborhood Center Development
■	T-5B : Transit-Oriented Development
■	T-6 : Industrial
■	PUD : Commercial PUD (By Agreement)
	HO : Historic Overlay District
	Village Limits
■	Park
■	Abandoned Railroad R/W Conservation Trail
■	Waste Water Treatment Plant

ADOPTED BY VILLAGE BOARD OF TRUSTEES:
 MARCH 18, 2021
 DATE

 SIGNATURE VILLAGE PRESIDENT

REVISIONS	
DATE:	BY:
March 19, 2020	Baxter & Woodman, Inc.
March 18, 2021	Baxter & Woodman, Inc.



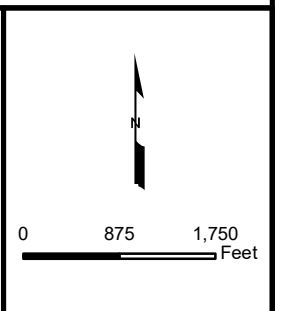

**VILLAGE OF RICHMOND
OFFICIAL ZONING MAP
MARCH 18, 2021**



Source(s): Various base data layers provided by McHenry County GIS.